

# B15 RATED WALL SYSTEM

Tongue and groove joint  $\alpha$  angle corner

# TYPE B-13-067

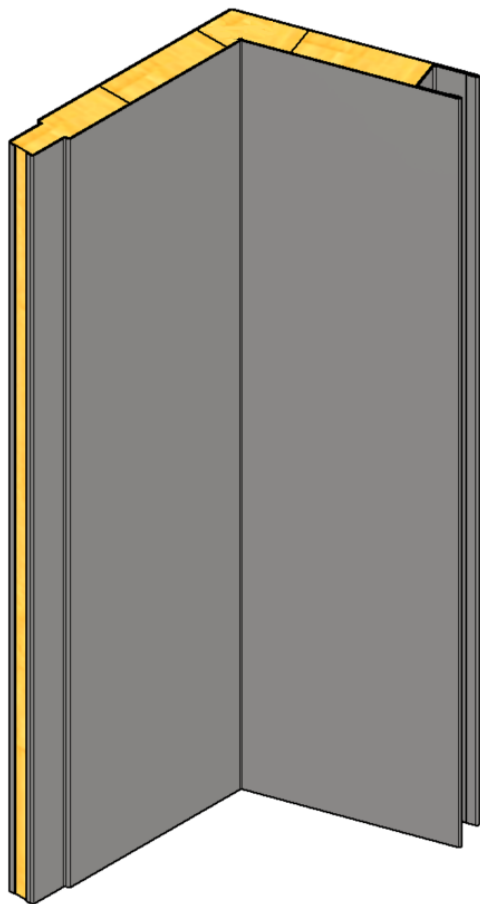

## GENERAL INFORMATIONS:

Fire class: B15

Standard panel width (B): 300, 450, 600 mm

Panel width (possible options) :

- 150-600 mm\* (B15 certified)
- up to 1000 mm\* (non- certified)

Standard panel height (H):

- up to 2600 mm\* (B15 certified)
- up to 3000 mm\* (non- certified)

Mass: 25mm – 15,4 kg/ m<sup>2</sup>  
50 mm – 20,0 kg/m<sup>2</sup>

## CROSS-SECTION:

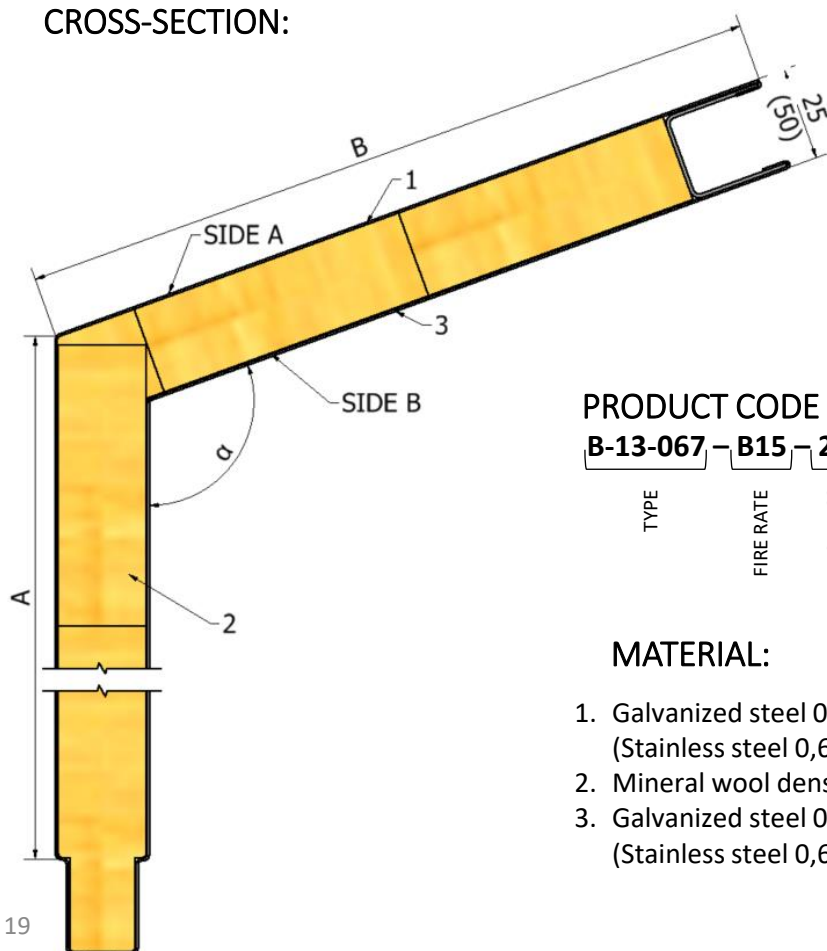

## JOINING METHOD:

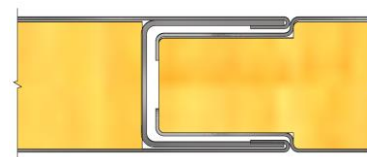

## PRODUCT CODE EXAMPLE:

<b>B-13-067</b>	<b>- B15</b>	<b>- 25</b>	<b>- 150x200x2400</b>	<b>- 110°</b>	<b>- Galv</b>	<b>- 9010</b>	<b>- Galv</b>
TYPE	FIRE RATE	THICKNESS	SIZE AxBxH	ANGLE $\alpha$	MATERIAL	1. FINISH	2. FINISH

## MATERIAL:

1. Galvanized steel 0,6 mm (Stainless steel 0,6 mm)
2. Mineral wool density 175 kg/m<sup>3</sup>
3. Galvanized steel 0,6 mm (Stainless steel 0,6 mm)

## FINISHING:

- RAL
- PVC Foil
- Galvanized steel
- Stainless steel

\*For more information, contact us.