

B15 RATED WALL SYSTEM

Standard tongue and groove joint

TYPE B-13-060

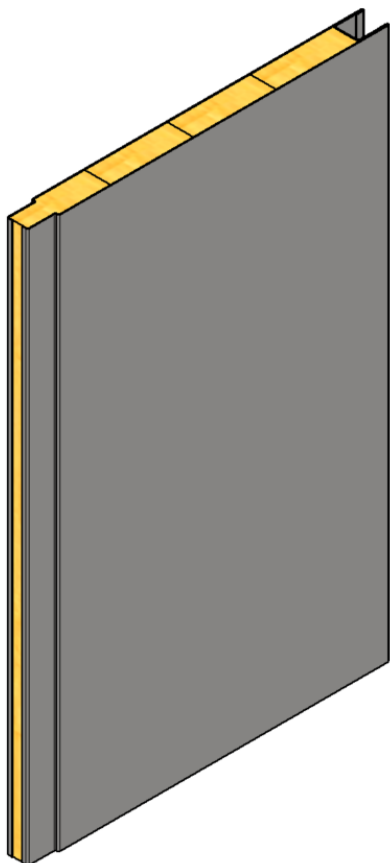

GENERAL INFORMATIONS:

Fire class: B15

Standard panel width (B): 300, 450, 600 mm

Panel width (possible options) :

- 150-600 mm* (B15 certified)
- up to 1000 mm* (non- certified)

Standard panel height (H):

- up to 2600 mm* (B15 certified)
- up to 3000 mm* (non- certified)

Mass: 25mm – 15,4 kg/ m²
50 mm – 20,0 kg/m²

Est. Sound red. (Rw): 25mm – 31 dB
50mm – 32 dB

CROSS-SECTION:

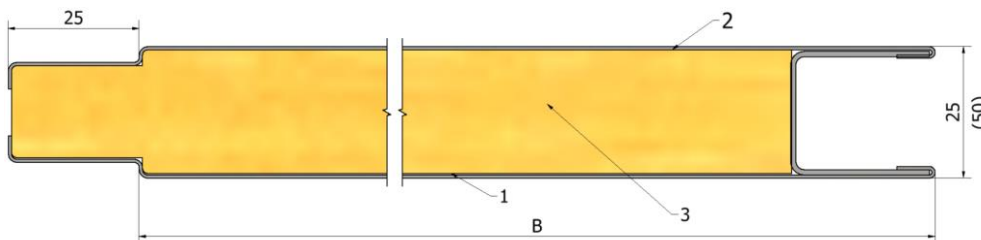

JOINING METHOD:

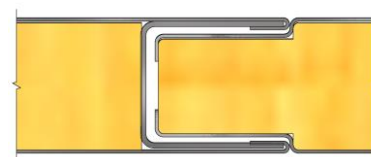

PRODUCT CODE EXAMPLE:

B-13-060 - B15 - 25 - 600x2000 - Galv - 9010 - Galv

TYPE	FIRE RATE	THICKNESS	SIZE BxH	MATERIAL	1. FINISH	2. FINISH
B-13-060	B15	25	600x2000	Galv	9010	Galv

MATERIAL:

- Galvanized steel 0,6 mm (Stainless steel 0,6 mm)
- Mineral wool density 175 kg/m³
- Galvanized steel 0,6 mm (Stainless steel 0,6 mm)

FINISHING:

- RAL
- PVC Foil
- Galvanized steel
- Stainless steel