

# B15 RATED WALL SYSTEM for wet areas

Snap connection with bottom V asymmetrical slot

# TYPE B-13-054

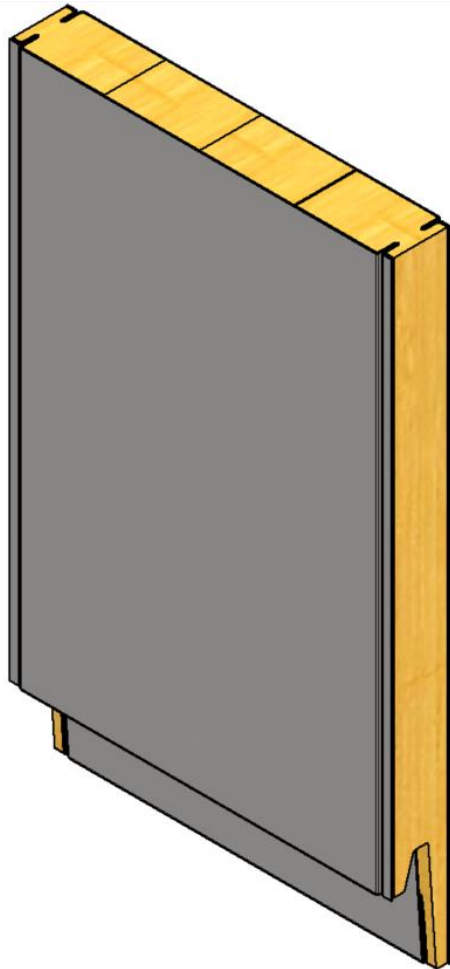

## GENERAL INFORMATIONS:

Fire class: B15

Standard panel width (B): 300, 450, 580 mm

Panel width (possible options) :

- 150-580 mm\* (B15 certified)
- up to 1000 mm\* (non- certified)

Standard panel height (H):

- up to 2600 mm\* (B15 certified)
- up to 3000 mm\* (non- certified)

Mass: 50 mm – 18,8 kg/ m<sup>2</sup>

## CROSS-SECTION:

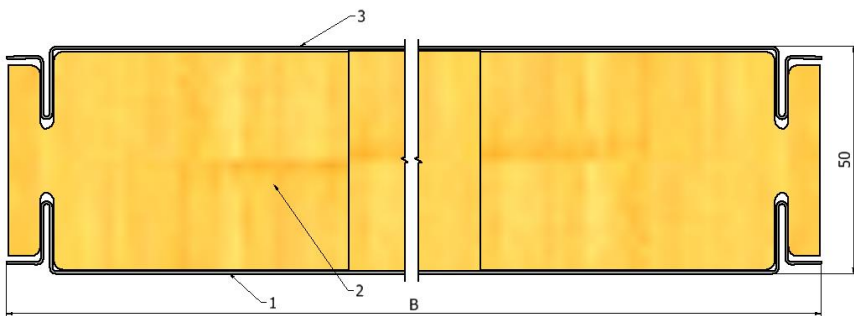

## JOINING METHOD:

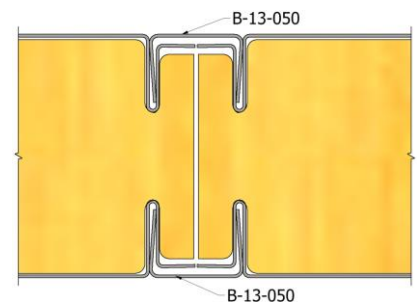

## PRODUCT CODE EXAMPLE:

<b>B-13-054</b>	<b>- B15</b>	<b>- 50</b>	<b>- 580x2000</b>	<b>- Galv</b>	<b>- 9010</b>	<b>- PVC</b>
TYPE	FIRE RATE	THICKNESS	SIZE BxH	MATERIAL	1. FINISH	2. FINISH

## BOTTOM SIDE:

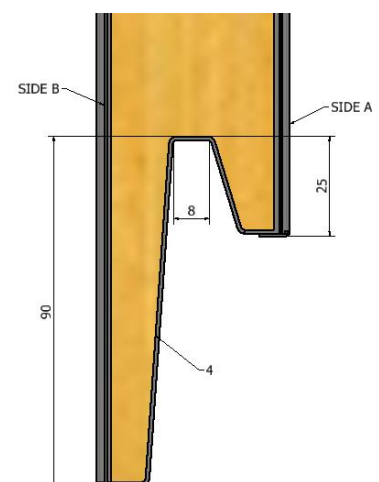

## MATERIAL:

1. Galvanized steel 0,6 mm (Stainless steel 0,6 mm)
2. Mineral wool density 175 kg/m<sup>3</sup>
3. Galvanized steel 0,6 mm (Stainless steel 0,6 mm)
4. Profile - Galvanized steel 1,0 mm (Stainless steel 1,0 mm)

## FINISHING:

- RAL
- PVC Foil
- Galvanized steel
- Stainless steel

\*For more information, contact us.