

# B15 RATED WALL SYSTEM

Tongue and groove joint with bottom straight slot

TYPE  
B-13-063

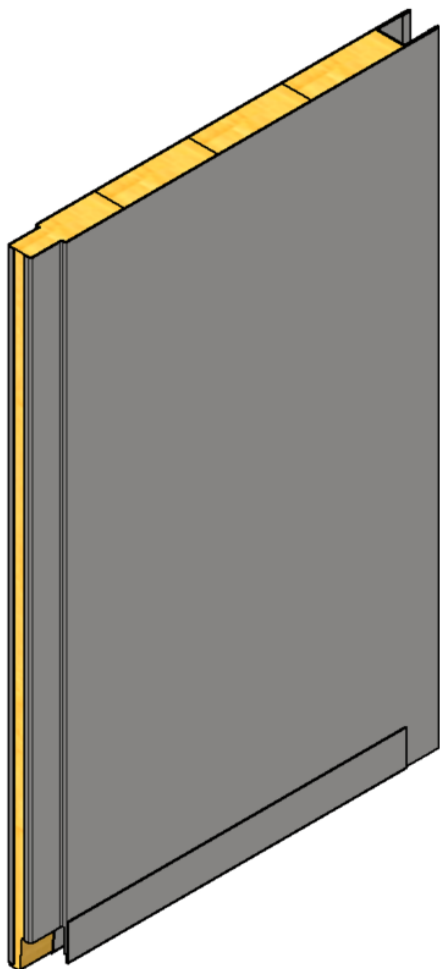

## GENERAL INFORMATION:

Fire class: B15

Standard panel width (B): 300, 450, 600 mm

Panel width (possible options) :

- 150-600 mm\* (B15 certified)
- up to 1000 mm\* (non- certified)

Standard panel height (H):

- up to 2600 mm\* (B15 certified)
- up to 3000 mm\* (non- certified)

Mass: 50 mm – 18,4 kg/m<sup>2</sup>

Est. Sound red. (Rw):

## CROSS-SECTION:

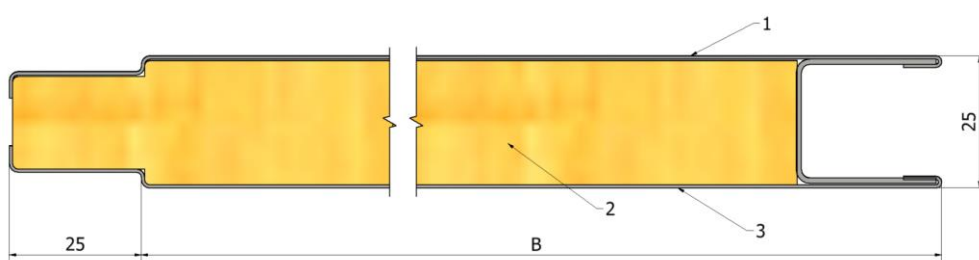

## JOINING METHOD:

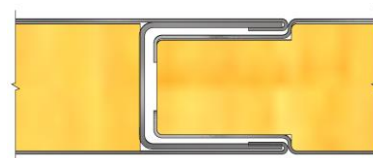

## PRODUCT CODE:

<b>B-13-063</b>	<b>B15</b>	<b>50</b>	<b>600x2000</b>	<b>Galv</b>	<b>9010</b>	<b>PVC</b>
TYPE	FIRE RATE	THICKNESS	SIZE BxH	MATERIAL	1. FINISH	2. FINISH

## MATERIAL:

1. Galvanized steel 0,6 mm  
(Stainless steel 0,6 mm)
2. Mineral wool density 175 kg/m<sup>3</sup>
3. Galvanized steel 0,6 mm  
(Stainless steel 0,6 mm)
4. Profile - Galvanized steel 1,0  
9 mm (Stainless steel 1,0 mm)

## FINISHING:

- RAL
- PVC Foil
- Galvanized steel
- Stainless steel

## BOTTOM SIDE:

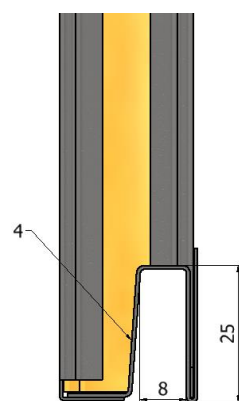

\*For more information, contact us.