

B15 RATED WALL SYSTEM

Straight edge

TYPE
B-13-062

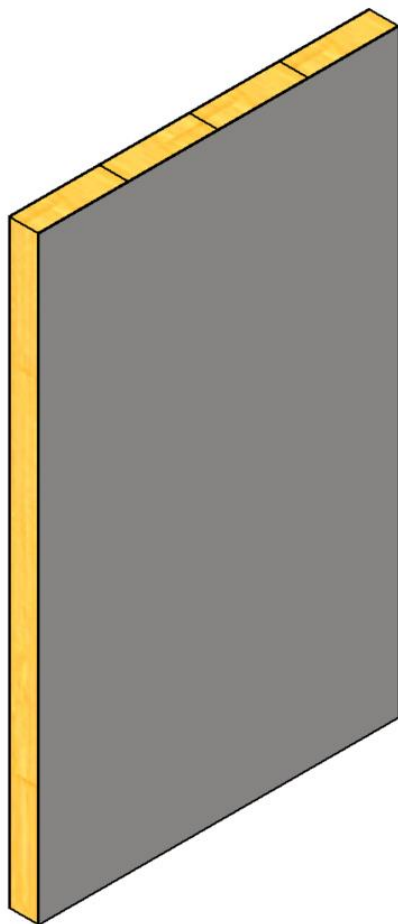

GENERAL INFORMATION:

Fire class: B15

Standard panel width (B): 300, 450, 600 mm

Panel width (possible options) :

- 150-600 mm* (B15 certified)
- up to 1000 mm* (non- certified)

Standard panel height (H):

- up to 2600 mm* (B15 certified)
- up to 3000 mm* (non- certified)

Mass: 25mm – 12,9 kg/ m²
50 mm – 17,7 kg/m²

Est. Sound red. (Rw):

CROSS-SECTION:

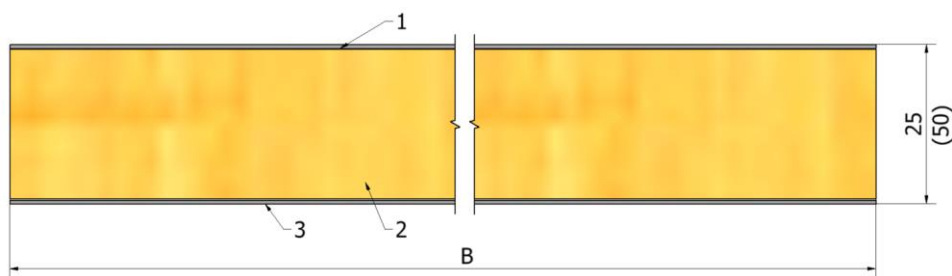

JOINING METHOD:

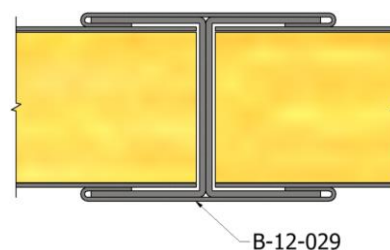

PRODUCT CODE:

| | | | | | | |
|-----------------|----------------|-------------|-------------------|---------------|---------------|-------------|
| B-13-062 | - B15 - | 50 - | 600x2000 - | Galv - | 9010 - | Galv |
| TYPE | FIRE RATE | THICKNESS | SIZE BxH | MATERIAL | 1. FINISH | 2. FINISH |

MATERIAL:

1. Galvanized steel 0,6 mm
(Stainless steel 0,6 mm)
2. Mineral wool density 175 kg/m³
3. Galvanized steel 0,6 mm
(Stainless steel 0,6 mm)

FINISHING:

- RAL
- PVC Foil
- Galvanized steel
- Stainless steel

