

# B15 RATED WALL SYSTEM

Lining panel with connection snap profile

TYPE  
B-13-049

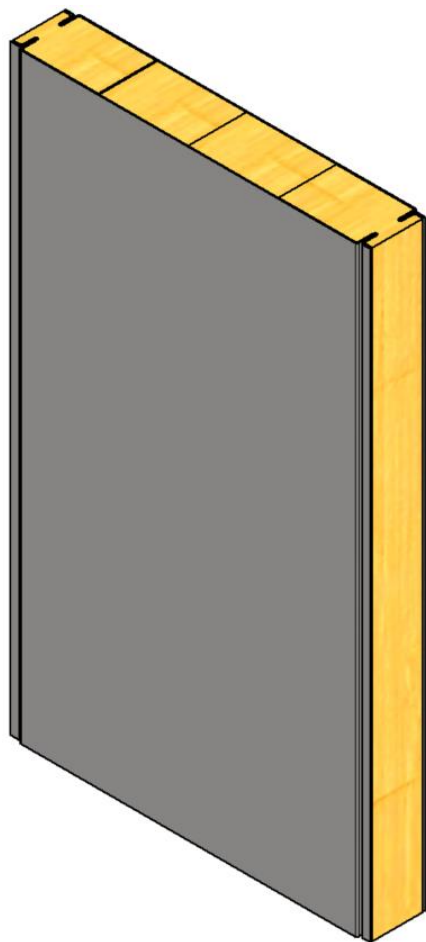

## GENERAL INFORMATION:

Fire class: B15

Standard panel width (B): 300, 450, 580 mm

Panel width (possible options) :

- 150-580 mm\* (B15 certified)
- up to 1000 mm\* (non- certified)

Standard panel height (H):

- up to 2600 mm\* (B15 certified)
- up to 3000 mm\* (non- certified)

Mass: 50 mm – 18,5 kg/m<sup>2</sup>

Est. Sound red. (Rw): 50mm – 36 dB

## CROSS-SECTION:

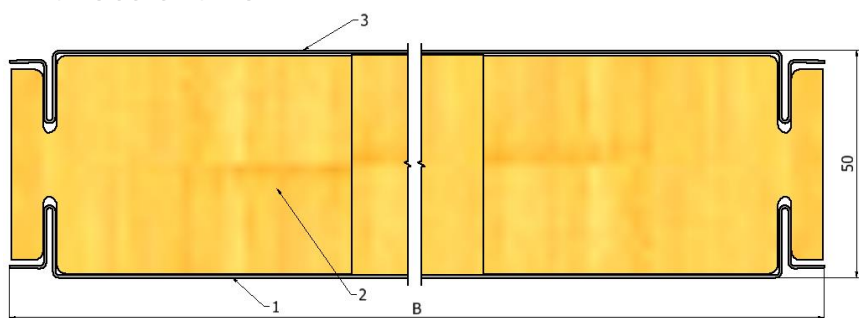

## JOINING METHOD:

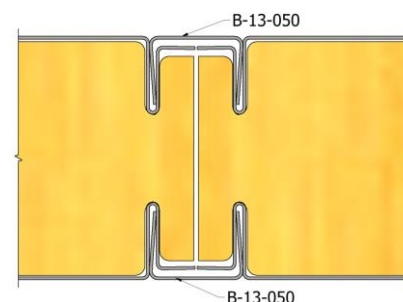

## PRODUCT CODE:

**B-13-049 – B15 – 50 – 580x2000 – Galv – 9010 – 9010**

TYPE

FIRE RATE

THICKNESS

SIZE BxH

MATERIAL

1. FINISH

2. FINISH

## MATERIAL:

1. Galvanized steel 0,6 mm  
(Stainless steel 0,6 mm)
2. Mineral wool density 175 kg/m<sup>3</sup>
3. Galvanized steel 0,6 mm  
(Stainless steel 0,6 mm)

## FINISHING:

- RAL
- PVC Foil
- Galvanized steel
- Stainless steel

\*For more information, contact us.